

COLLEGE HIGHWAY

HIGH SEAT

W. J. LYMAN 1-44	
STEPHEN LYMAN 1-43	
E. FOOTE 1-42	C. L. LYMAN 1-41
S. HANNUM 1-40	A. W. LYMAN 1-39
M. S. HANNUM 1-38	F. P. CRIPPS 1-37
J. S. FRARY 1-36	J. T. CLAPP 1-35
JACOB FRARY 1-34	C. FRARY 1-33
SAMUEL PATRICK 1-32	C. H. FRARY 1-31
A. C. FRARY 1-30	E. R. HILL 1-29
J. RUSSELL 1-28	RUSSELL ROOT 1-27
CHAS. LYON 1-26	RUFUS LYMAN H. B. LYMAN 1-25
HENRY CARRIER 1-24	C. OLDS G. DAVID 1-23
F. A. KNOX 1-22	H. E. CALLEMAN 1-21

SECTION ONE  
REAR

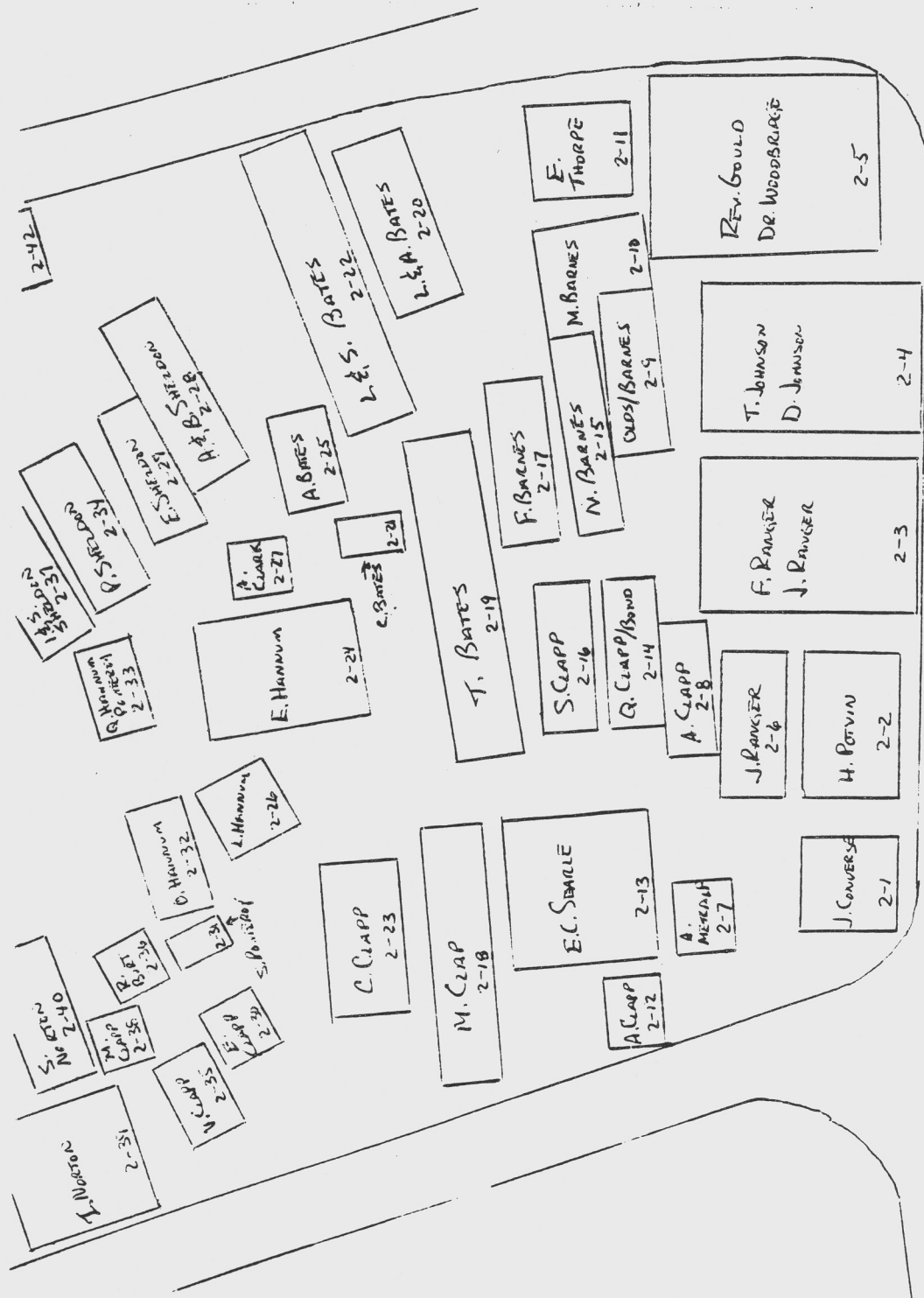

## Section Two

College Highway

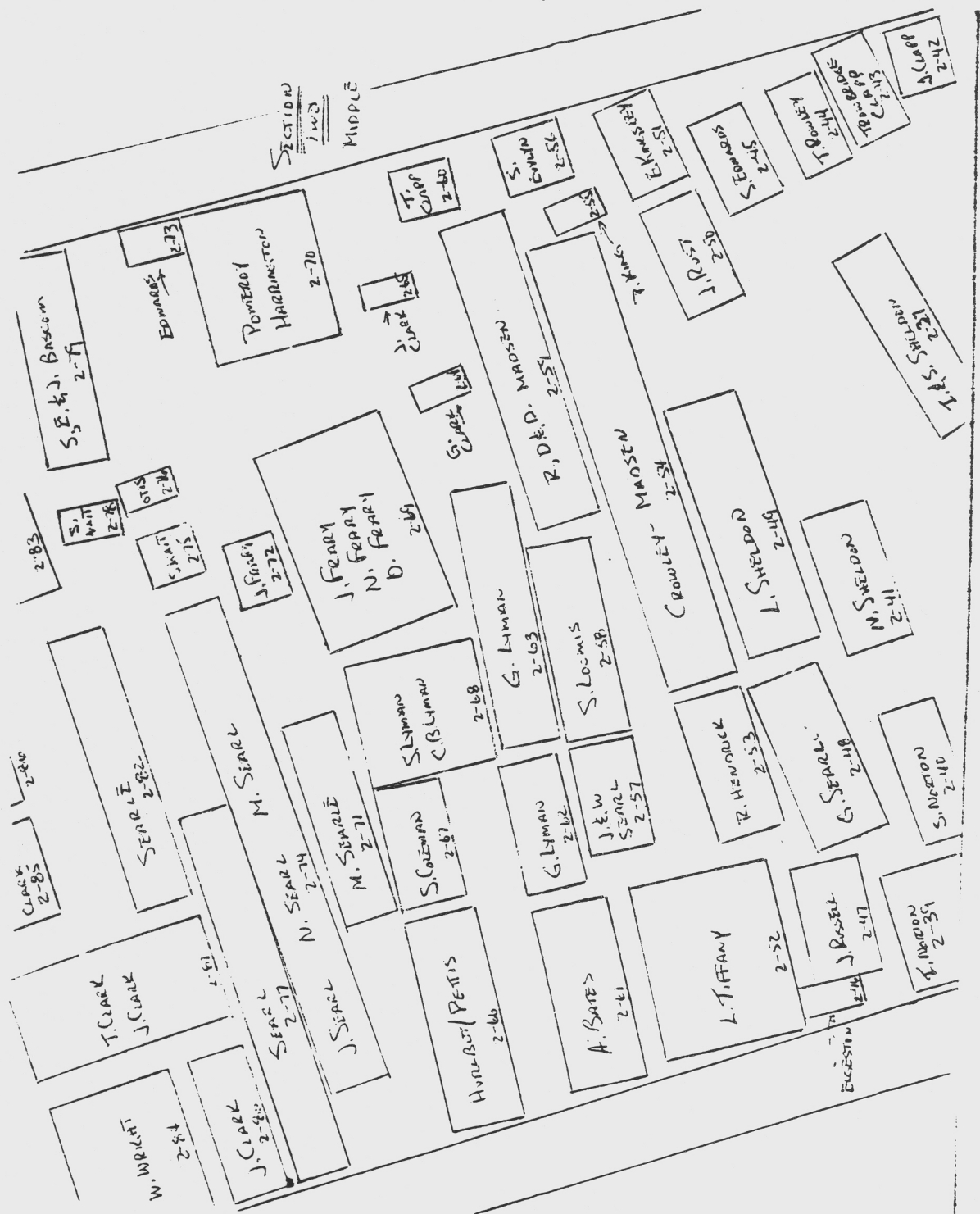



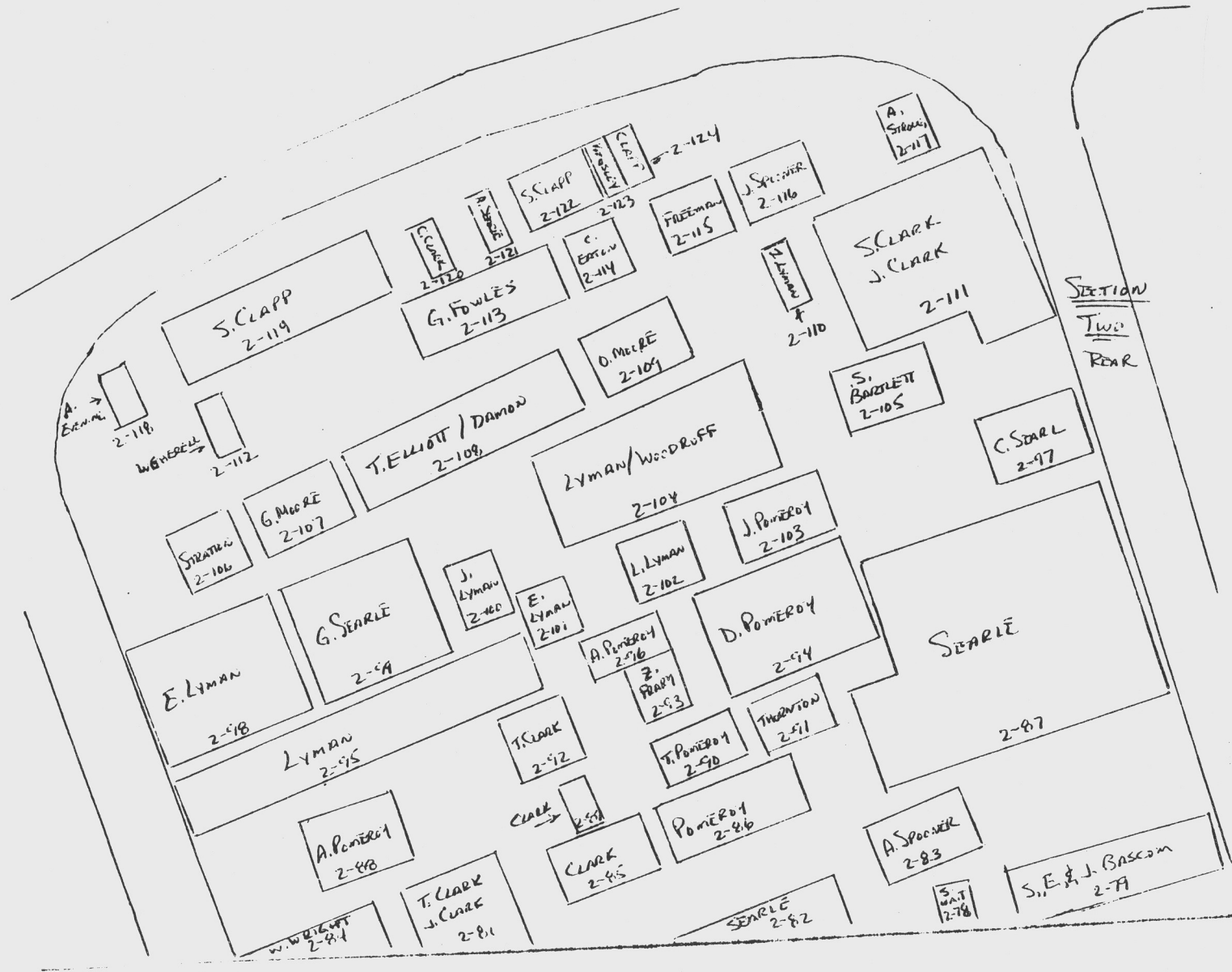

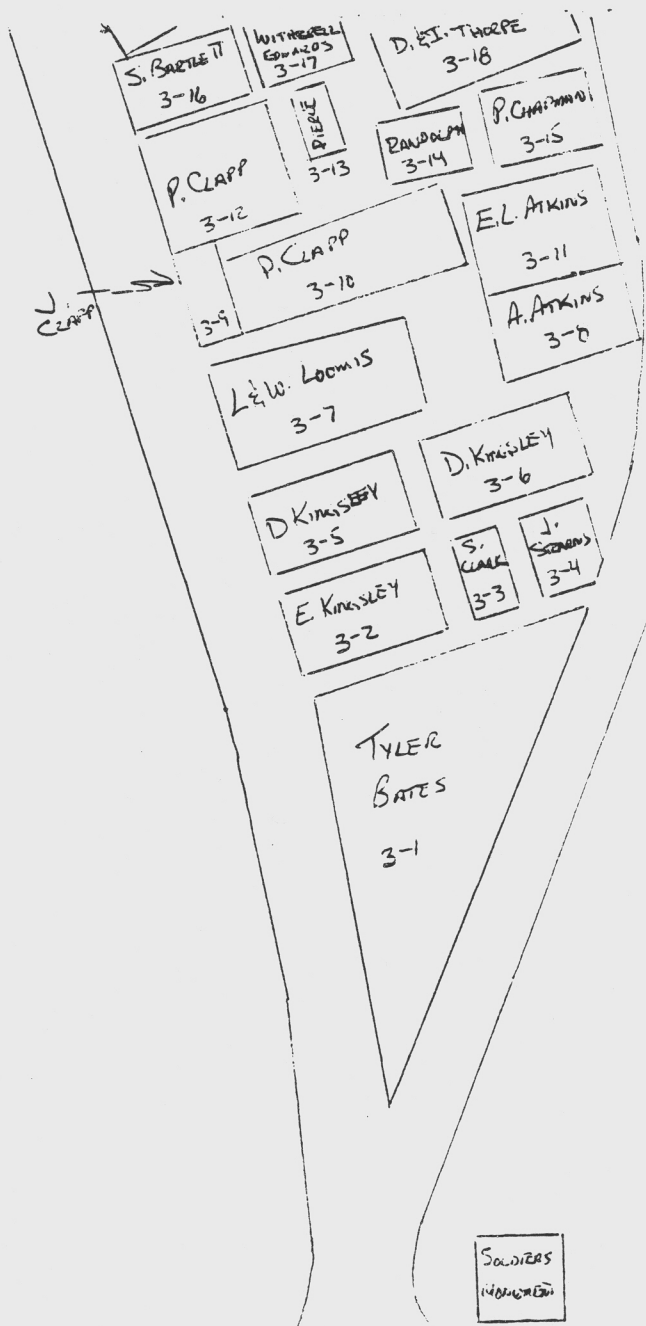

SECTION THREE  
COLLEGE HIGHWAY

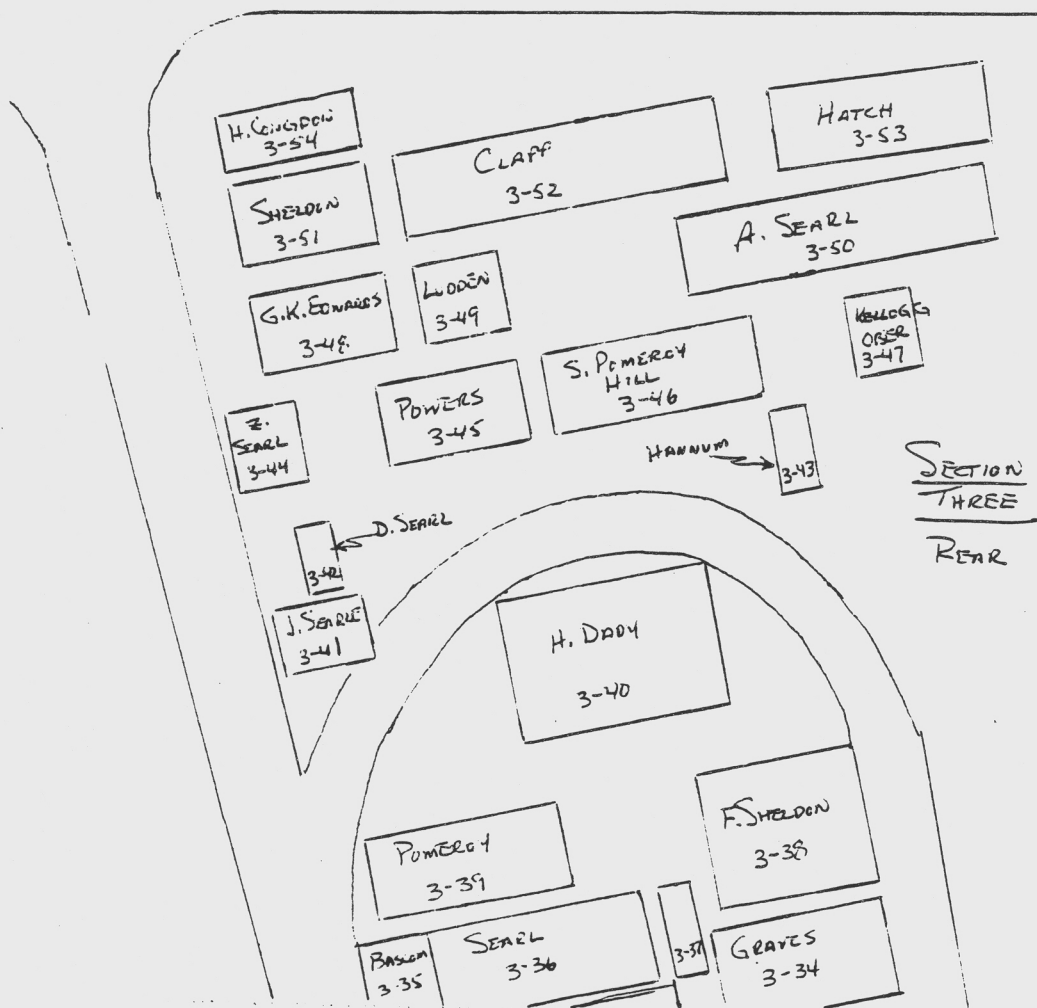

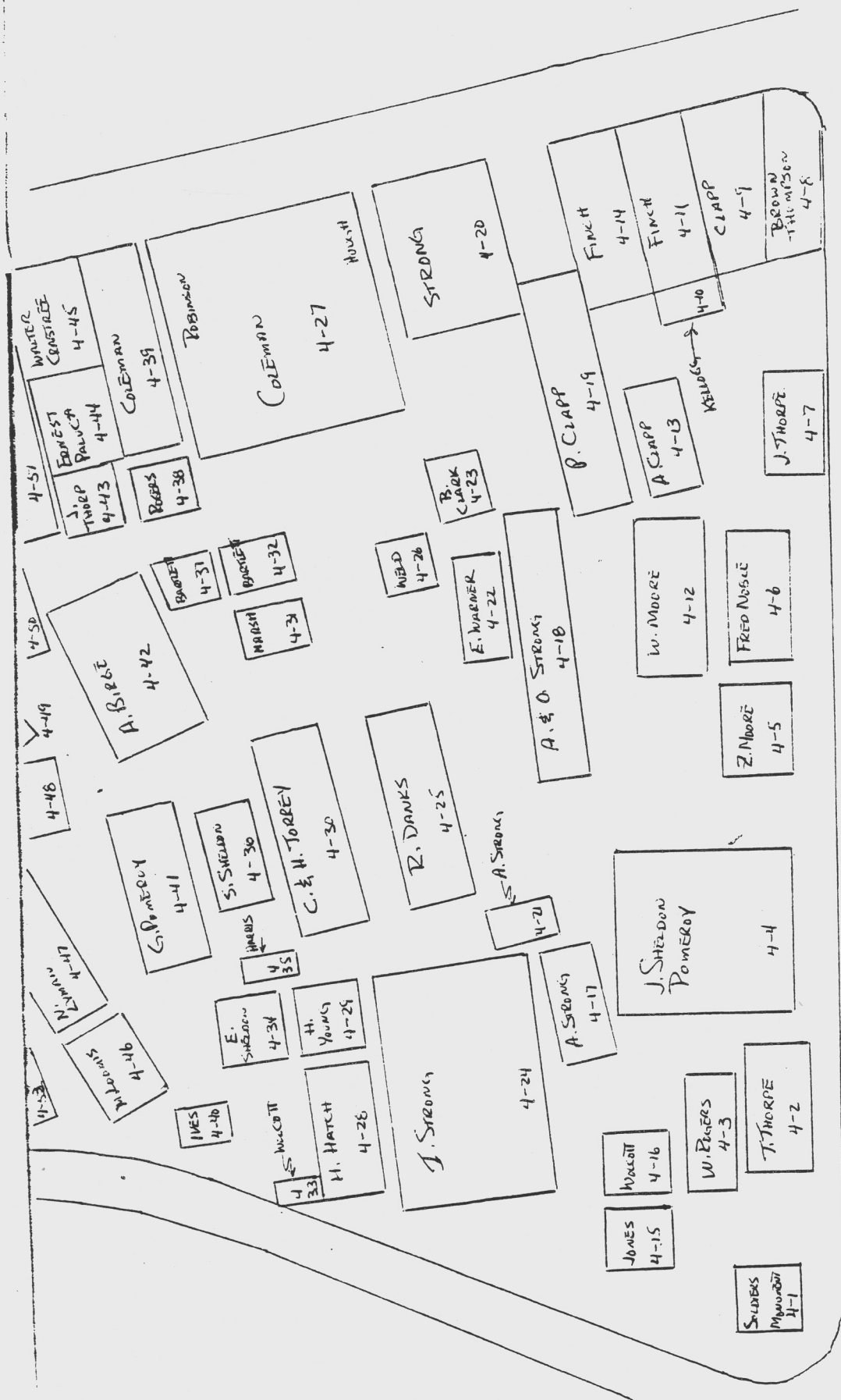

# Section Four

COLLEGE HIGHWAY

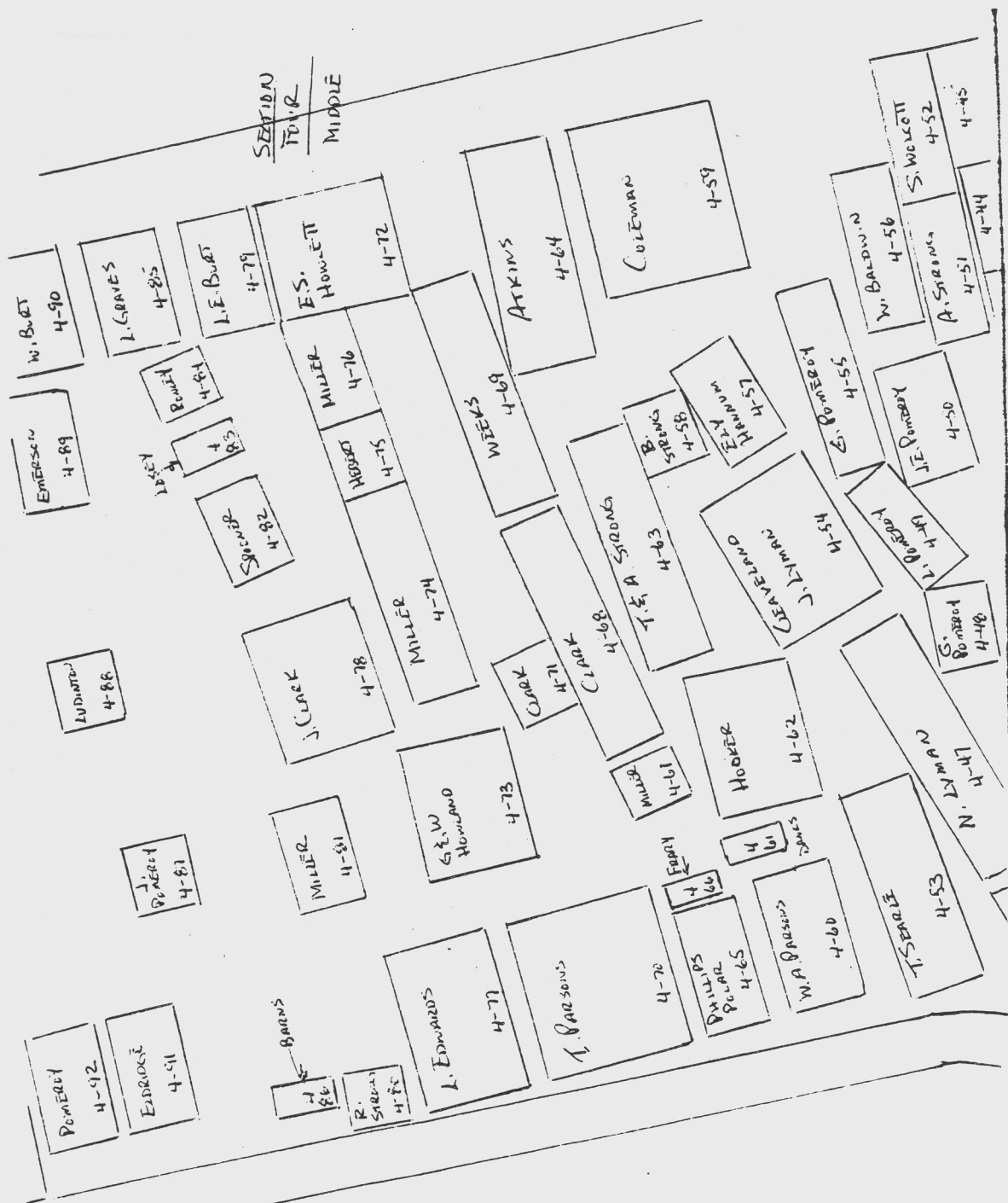

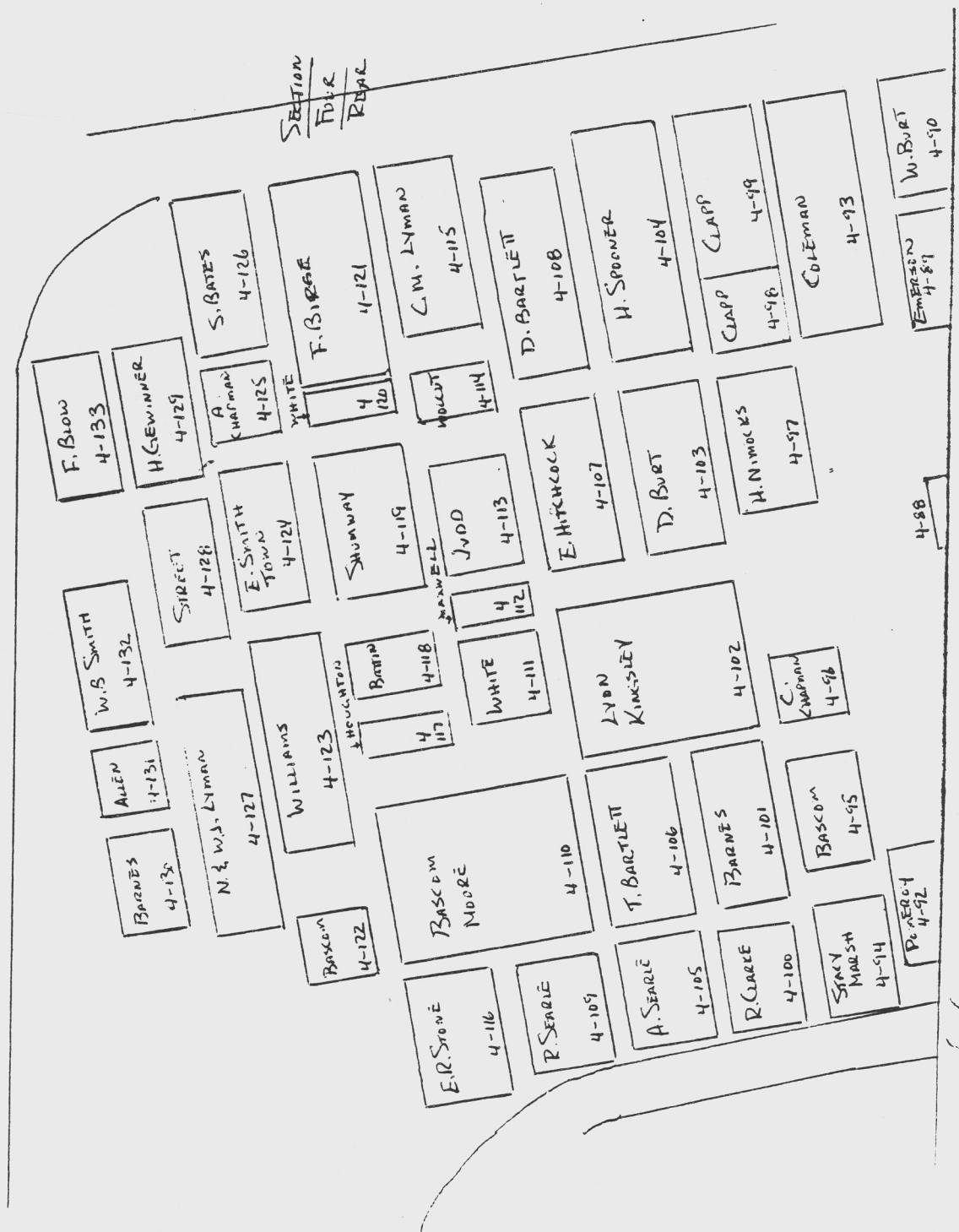

W. POMEROY 5-23	G. HYDE 5-24
G. WOLCOTT 5-21	N. SPOONER 5-22
A. WOLCOTT 5-19	J. WOLCOTT 5-20
A. SMITH 5-17	H. QUIGLEY 5-18
D. ELY 5-15	D. PHELPS 5-16
B. NORTON 5-13	R. F. HATCH 5-14
M. SHELDON 5-11	L. O. FEARY 5-12
E. SWAN 5-9	A. DELANEY 5-10
A. STROM 5-7	W. DELANEY 5-8
L. MORGAN 5-5	A. NILES 5-6
L. HAYDEN 5-3	B. NILES 5-4
E. THORPE 5-1	A. WARRINER 5-2

SECTION FIVE

COLLEGE HIGHWAY

S-47	
G. GORTON S-45	N. FRARY S-46
W. CHENEY S-43	G. SEARLE S-44
R.E. BOWDEN S-41	H.A. BOSWORTH S-42
BARNES S-39	S.B. SHELDON S-40
L.R. BARTLETT S-37	E.A. EDWARDS S-38
E. GRAVES S-35	G. HALL S-36
D. SEARLE S-33	F. HUGHES S-34
J. MILLER S-31	R. LOOMIS S-32
C. SHELDON H. HATCH S-29	L. CLARK S-30
J. BOYD S-27	A. POMEROY S-28
R. DOUGLAS S-25	T. BARTLETT S-26
W. POMEROY S-23	G. HYDE S-24
	S-22

SECTION  
FIVE  
MIDDLE



UNKNOWN S-60  
 UNKNOWN S-59  
 ALDRICH S-59

S. DUNLOP S-55  
 F. ANDERSON S-56  
 E. BELL S-57  
 RADHINE S-58  
 F. SHERMAN S-61

M. BLODGETT S-53  
 G. MARENGO S-54  
 J. BARNETT S-51  
 J. RANSEY S-52  
 D. CHAPMAN S-49  
 I. WOLCOTT S-50  
 H. WITHERELL S-47  
 N. FRARY S-48  
 G. GORTON S-45  
 N. FRARY S-46  
 S-44

SECTION  
 FIVE  
 REAR

